

## INDUSTRIAL SPACE FOR LEASE

**VARNFIELD  
BUSINESS PARK**  
200 VARNFIELD DRIVE  
SUMMERVILLE, SC 29483

Suite C - 4,023 SF



**Grace Moring, Leasing**  
843.518.6808  
gmoring@wrsrealty.com

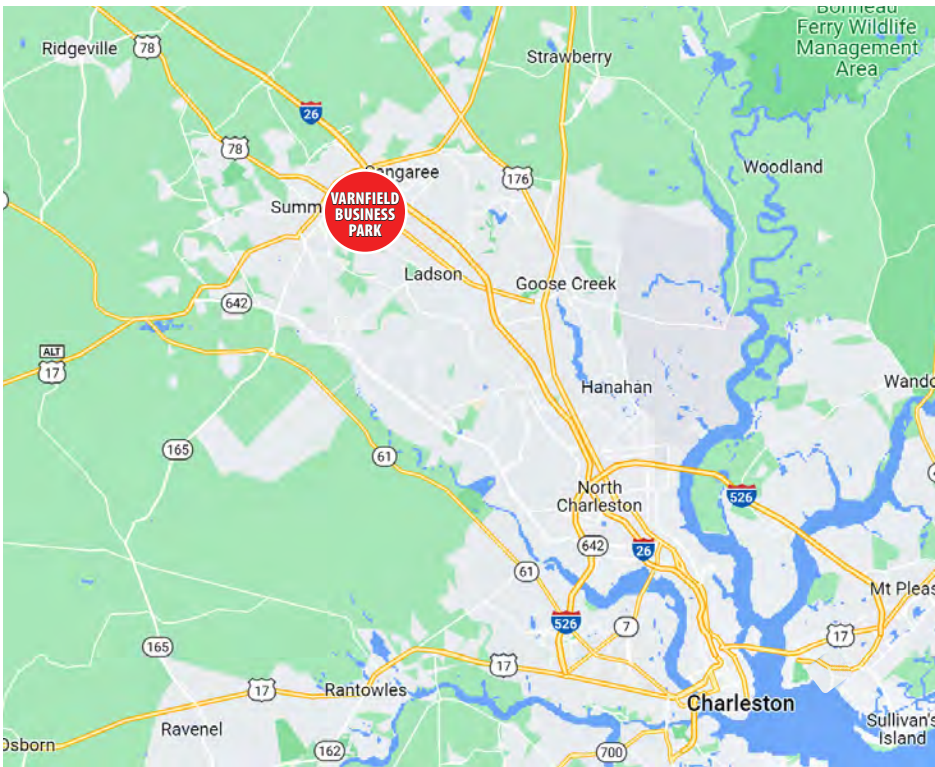

## OFFERING SUMMARY

<b>Address</b>	200 Varnfield Drive Summerville, SC 29483
<b>Zoning</b>	Light Industrial
<b>County</b>	Berkeley County
<b>Municipality</b>	North Charleston
<b>Lease Type</b>	NNN
<b>Available SF</b>	200 Varnfield Suite C - 4,023 SF
<b>Eave Height</b>	20'
<b>Clear Height</b>	23'
<b>Sprinkler</b>	Wet System
<b>Fans</b>	HVLS

## THE PROPERTY

Varnfield Business Park is located just off of North Main Street and I-26 at Exit 199 in Summerville. The industrial park is in close proximity to the Charleston Port Terminals, Charleston International Airport and local manufacturers such as Mercedes, Boeing, Volvo, and Bosch.

Unit C is 4,023 SF with 1,250 SF of fully-conditioned office space and 2,750 SF of warehouse. The space is equipped with two drive-in warehouse doors - 10' x 14' & 8' x 10'. Established industrial and retail businesses immediately surround the property.

# 200 VARNFIELD FLOOR PLAN

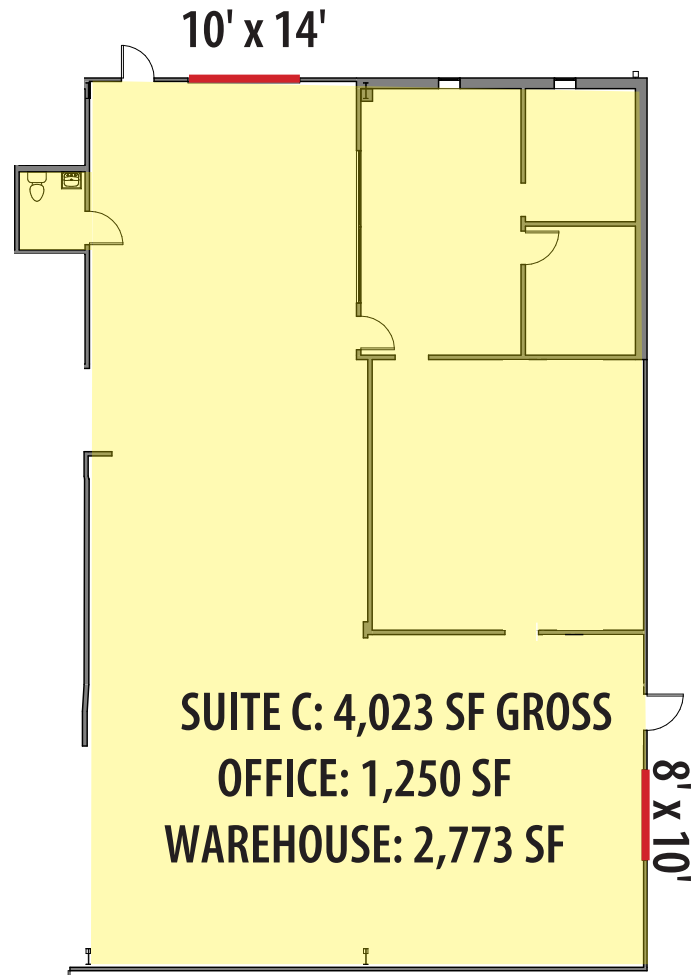



# 200 VARNFIELD PHOTOS



# LOCATION





---

**WRS**INC  
REAL ESTATE INVESTMENTS

410 Mill Street, Bldg. 1, Suite 200  
Mount Pleasant, SC 29464  
843.654.7888 Office  
843.654.7889 Fax  
[www.wrsrealstate.com](http://www.wrsrealstate.com)